



GLENDAL
Arizona

CITY OF GLENDALE, ARIZONA

**DEVELOPMENT IMPACT FEE
UNAUDITED**

STATEMENT OF REVENUES, EXPENDITURES AND CHANGES IN FUND BALANCE

As of June 30, 2011

**ACCOUNTING FOR THE COLLECTION AND USE OF DEVELOPMENT IMPACT FEES
ANNUAL REPORT**

Table of Contents

Development Impact Fee Schedule	1
Unaudited Statement of Revenue, Expenditures, and Change in Fund Balance	
Development Impact Fee Account Summary – Government Funds	2
Detailed Development Impact Fee Expenditure Report – Government Funds	3
Development Impact Fee Account Summary – Enterprise Funds	5
Detailed Development Impact Fee Expenditure Report – Enterprise Funds	6

City of Glendale Map

Appendix A

SCHEDULE OF COMMUNITY DEVELOPMENT IMPACT FEES
September 2006

Residential (per unit)	Library	Parks, Rec, Open Space	Police	Fire	General Gov't	Solid Waste	Roadway Improvements	Water System	Sewer System	TOTAL
Single-Family	\$606	\$2,072	\$395	\$409	\$847	\$301	\$1,160			\$5,790
Multi-Family	\$455	\$1,555	\$297	\$307	\$635	\$58	\$591			\$3,898
All Other Residential	\$476	\$1,627	\$310	\$321	\$665	\$60	\$682			\$4,141
Nonresidential (per 1,000 square feet)										
Com/Shop Ctr 50,000 SF or less			\$655	\$346	\$780	\$81	\$4,686			\$6,548
Com/Shop Ctr 50,001-100,000 SF			\$578	\$303	\$682	\$71	\$4,131			\$5,765
Com/Shop Ctr 100,001-200,000 SF			\$504	\$269	\$606	\$63	\$3,604			\$5,046
Com/Shop Ctr over 200,000 SF			\$435	\$242	\$546	\$57	\$3,114			\$4,394
Office/Inst 25,000 SF or less			\$679	\$503	\$1,133	\$118	\$4,858			\$7,291
Office/Inst 25,001-50,000 SF			\$429	\$474	\$1,067	\$111	\$3,072			\$5,153
Office/Inst 50,001-100,000 SF			\$304	\$447	\$1,007	\$105	\$2,173			\$4,036
Office/Inst over 100,000 SF			\$242	\$406	\$914	\$95	\$1,729			\$3,386
Business Park			\$205	\$383	\$862	\$90	\$1,467			\$3,007
Light Industrial			\$171	\$280	\$630	\$66	\$1,228			\$2,375
Manufacturing			\$119	\$217	\$488	\$51	\$853			\$1,728
Warehousing			\$97	\$155	\$349	\$36	\$694			\$1,331
Meter Size (inches)										
0.75					\$6,660			\$2,330		\$8,990
1.00					\$11,330			\$3,960		\$15,290
1.50					\$21,990			\$7,690		\$29,680
2.00					\$35,310			\$12,350		\$47,660
3.00					\$73,290			\$25,640		\$98,930
4.00					\$113,270			\$39,630		\$152,900
6.00					\$221,880			\$77,620		\$299,500
8.00					\$333,150			\$116,550		\$449,700

City of Glendale
 Development Impact Fee Report
 Unaudited - Statement of Revenue, Expenditures, and Change in Fund Balances
 For Fiscal Year Ending June 30, 2011

Development Impact Fee Account Summary - Government Funds

	Fund 1380	Fund 1420	Fund 1440	Fund 1460	Fund 1480	Fund 1500	Fund 1520	Fund 1540	Fund 1560	Fund 1580	Fund 1600	Fund 1620	Total
FY10 Annual Report Ending Balance	\$ 1,723,683.67	\$ 91,722.19	\$ 1,269,056.18	\$ 158,411.65	\$ 1,442,325.39	\$ 3,352,239.76	\$ 333,271.34	\$ 88,314.07	\$ 162,832.86	\$ 51,311.79	\$ 3,374,687.89	\$ (455.41)	\$ 12,047,401.38
Transfer to consolidate program	\$ -	\$ -	\$ -	\$ -	\$ -	\$ -	\$ -	\$ -	\$ -	\$ -	\$ -	\$ -	\$ -
Revenue Adjustment	\$ -	\$ -	\$ -	\$ -	\$ -	\$ -	\$ -	\$ -	\$ -	\$ -	\$ -	\$ -	\$ -
Expenditure Adjustment	\$ -	\$ -	\$ -	\$ -	\$ -	\$ -	\$ -	\$ -	\$ -	\$ -	\$ -	\$ -	\$ -
Beginning Balance at July 1, 2010	\$ 1,723,683.67	\$ 91,722.19	\$ 1,269,056.18	\$ 158,411.65	\$ 1,442,325.39	\$ 3,352,239.76	\$ 333,271.34	\$ 88,314.07	\$ 162,832.86	\$ 51,311.79	\$ 3,374,687.89	\$ (455.41)	\$ 12,047,401.38

Revenues

	Fund 1380	Fund 1420	Fund 1440	Fund 1460	Fund 1480	Fund 1500	Fund 1520	Fund 1540	Fund 1560	Fund 1580	Fund 1600	Fund 1620	Total
Total Amount of Impact Fees Collected	\$ -	\$ 57,697.15	\$ 55,378.66	\$ 41,638.00	\$ 44,690.00	\$ 66,054.00	\$ 101,697.00	\$ 27,066.00	\$ 9,369.00	\$ 1,388.00	\$ 292,685.50	\$ 121,847.42	\$ 819,510.73
Other Earnings	\$ -	\$ -	\$ -	\$ -	\$ -	\$ -	\$ -	\$ -	\$ -	\$ -	\$ -	\$ -	\$ -
Interest Earned on Each Account	\$ 8,670.00	\$ 586.00	\$ 6,510.00	\$ 897.00	\$ 7,364.00	\$ 16,373.00	\$ 1,924.00	\$ 506.00	\$ 844.00	\$ 264.00	\$ 16,845.00	\$ 264.00	\$ 61,047.00
Total Revenues	\$ 8,670.00	\$ 58,283.15	\$ 61,888.66	\$ 42,535.00	\$ 52,054.00	\$ 82,427.00	\$ 103,621.00	\$ 27,572.00	\$ 10,213.00	\$ 1,652.00	\$ 309,530.50	\$ 122,111.42	\$ 880,557.73

Expenditures

	Fund 1380	Fund 1420	Fund 1440	Fund 1460	Fund 1480	Fund 1500	Fund 1520	Fund 1540	Fund 1560	Fund 1580	Fund 1600	Fund 1620	Total
Total Capital Project Expenditures	\$ -	\$ -	\$ -	\$ -	\$ -	\$ 182,735.13	\$ -	\$ -	\$ -	\$ -	\$ 86,673.77	\$ -	\$ 269,408.90
Bonds	\$ -	\$ -	\$ -	\$ -	\$ -	\$ -	\$ -	\$ -	\$ -	\$ -	\$ 910,000.00	\$ -	\$ 910,000.00
Principal	\$ -	\$ -	\$ 155,104.00	\$ 205,603.00	\$ -	\$ -	\$ -	\$ -	\$ -	\$ -	\$ 90,000.00	\$ -	\$ 350,707.00
Interest	\$ -	\$ -	\$ 6,204.00	\$ 8,224.00	\$ -	\$ -	\$ -	\$ -	\$ -	\$ -	\$ 1,000,000.00	\$ -	\$ 1,014,428.00
Debt Service on Bonds (Total Paid)	\$ -	\$ -	\$ 161,308.00	\$ 213,827.00	\$ -	\$ -	\$ -	\$ -	\$ -	\$ -	\$ 1,000,000.00	\$ -	\$ 1,375,135.00
Capital Leases	\$ -	\$ -	\$ -	\$ -	\$ -	\$ -	\$ -	\$ -	\$ -	\$ -	\$ -	\$ -	\$ -
Principal	\$ -	\$ -	\$ -	\$ -	\$ -	\$ -	\$ -	\$ -	\$ -	\$ -	\$ -	\$ -	\$ -
Interest	\$ -	\$ -	\$ -	\$ -	\$ -	\$ -	\$ -	\$ -	\$ -	\$ -	\$ -	\$ -	\$ -
Payment on Capital Leases (Total Paid)	\$ -	\$ -	\$ -	\$ -	\$ -	\$ -	\$ -	\$ -	\$ -	\$ -	\$ -	\$ -	\$ -
Other Expenditures	\$ -	\$ -	\$ -	\$ -	\$ -	\$ -	\$ -	\$ -	\$ -	\$ -	\$ -	\$ -	\$ -
Advances from Other Funds	\$ -	\$ -	\$ -	\$ -	\$ -	\$ -	\$ -	\$ -	\$ -	\$ -	\$ -	\$ -	\$ -
Total Expenditures	\$ -	\$ -	\$ 161,308.00	\$ 213,827.00	\$ -	\$ 182,735.13	\$ -	\$ -	\$ -	\$ -	\$ 86,673.77	\$ -	\$ 434,543.90

FY11 End of Year Balance

	Fund 1380	Fund 1420	Fund 1440	Fund 1460	Fund 1480	Fund 1500	Fund 1520	Fund 1540	Fund 1560	Fund 1580	Fund 1600	Fund 1620	Total
Beginning Balance	\$ 1,723,683.67	\$ 91,722.19	\$ 1,269,056.18	\$ 158,411.65	\$ 1,442,325.39	\$ 3,352,239.76	\$ 333,271.34	\$ 88,314.07	\$ 162,832.86	\$ 51,311.79	\$ 3,374,687.89	\$ (455.41)	\$ 12,047,401.38
Total Revenues	\$ 8,670.00	\$ 58,283.15	\$ 61,888.66	\$ 42,535.00	\$ 52,054.00	\$ 82,427.00	\$ 103,621.00	\$ 27,572.00	\$ 10,213.00	\$ 1,652.00	\$ 309,530.50	\$ 122,111.42	\$ 880,557.73
Total Expenditures	\$ -	\$ -	\$ 161,308.00	\$ 213,827.00	\$ -	\$ 182,735.13	\$ -	\$ -	\$ -	\$ -	\$ 86,673.77	\$ -	\$ 434,543.90
Ending Balance as of June 30, 2011	\$ 1,732,353.67	\$ (11,302.66)	\$ 1,117,117.84	\$ 200,946.65	\$ 1,494,379.39	\$ 3,251,931.63	\$ 436,892.34	\$ 115,886.07	\$ 173,045.86	\$ 52,963.79	\$ 2,597,544.62	\$ 121,656.01	\$ 11,283,415.21

City of Glendale
 Development Impact Fee Report
 Unaudited - Statement of Revenue, Expenditures, and Change in Fund Balances
 For Fiscal Year Ending June 30, 2011

Development Impact Fee Account Summary - Enterprise Funds

	Fund 2380	Fund 2380	Fund 2440	Fund 2440	Fund 2440	Fund 2440	Fund 2480	Total
	Water	Sewer	Landfill Machinery	Recycling	Materials Recovery	Sanitation		
Beginning Balance at July 1, 2010	\$ -	\$ -	\$ -	\$ -	\$ -	\$ -	\$ -	\$ -

Revenues

Total Amount of Impact Fees Collected	\$ 1,033,130.00	\$ 335,520.00	\$ 1,059,43	\$ 15,260.00	\$ 6,431.00	\$ 9,156.00	\$ 1,400,556.43	
Other Earnings	\$ -	\$ -	\$ -	\$ -	\$ -	\$ -	\$ -	\$ -
Interest Earned on Each Account	\$ -	\$ -	\$ -	\$ -	\$ -	\$ -	\$ -	\$ -
Total Revenues	\$ 1,033,130.00	\$ 335,520.00	\$ 1,059,43	\$ 15,260.00	\$ 6,431.00	\$ 9,156.00	\$ 1,400,556.43	

Expenditures

	Fund 2380	Fund 2380	Fund 2440	Fund 2440	Fund 2440	Fund 2480	Total
	Water	Sewer	Landfill Machinery	Recycling	Materials Recovery	Sanitation	
Total Capital Project Expenditures	\$ -	\$ -	\$ 1,059,43	\$ 15,260.00	\$ 6,431.00	\$ -	\$ 22,750.43

Bonds							
Principal	\$ 477,512.69	\$ 155,077.34	\$ -	\$ -	\$ -	\$ -	\$ 632,590.03
Interest	\$ 555,617.31	\$ 180,442.66	\$ -	\$ -	\$ -	\$ -	\$ 736,059.97
Debt Service on Bonds (Total Paid)	\$ 1,033,130.00	\$ 335,520.00	\$ -	\$ -	\$ -	\$ -	\$ 1,368,650.00
Capital Lease							
Principal	\$ -	\$ -	\$ -	\$ -	\$ -	\$ 8,705.52	\$ 8,705.52
Interest	\$ -	\$ -	\$ -	\$ -	\$ -	\$ 450.48	\$ 450.48
Payment on Capital Lease (Total Paid)	\$ -	\$ -	\$ -	\$ -	\$ -	\$ 9,156.00	\$ 9,156.00

Other Expenditures	\$ -	\$ -	\$ -	\$ -	\$ -	\$ -	\$ -
Advances from Other Funds	\$ -	\$ -	\$ -	\$ -	\$ -	\$ -	\$ -
Total Expenditures	\$ 1,033,130.00	\$ 335,520.00	\$ 1,059,43	\$ 15,260.00	\$ 6,431.00	\$ 9,156.00	\$ 1,400,556.43

FY11 End of Year Balance

	Fund 2380	Fund 2380	Fund 2440	Fund 2440	Fund 2440	Fund 2480	Total
	Water	Sewer	Landfill Machinery	Recycling	Materials Recovery	Sanitation	
Total Beginning Balance	\$ -	\$ -	\$ -	\$ -	\$ -	\$ -	\$ -
Total Revenues	\$ 1,033,130.00	\$ 335,520.00	\$ 1,059,43	\$ 15,260.00	\$ 6,431.00	\$ 9,156.00	\$ 1,400,556.43
Total Expenditures	\$ 1,033,130.00	\$ 335,520.00	\$ 1,059,43	\$ 15,260.00	\$ 6,431.00	\$ 9,156.00	\$ 1,400,556.43
Ending Balance as of June 30, 2011	\$ -	\$ -	\$ -	\$ -	\$ -	\$ -	\$ -

APPENDIX

A

Glendale Parks and Recreation Facilities

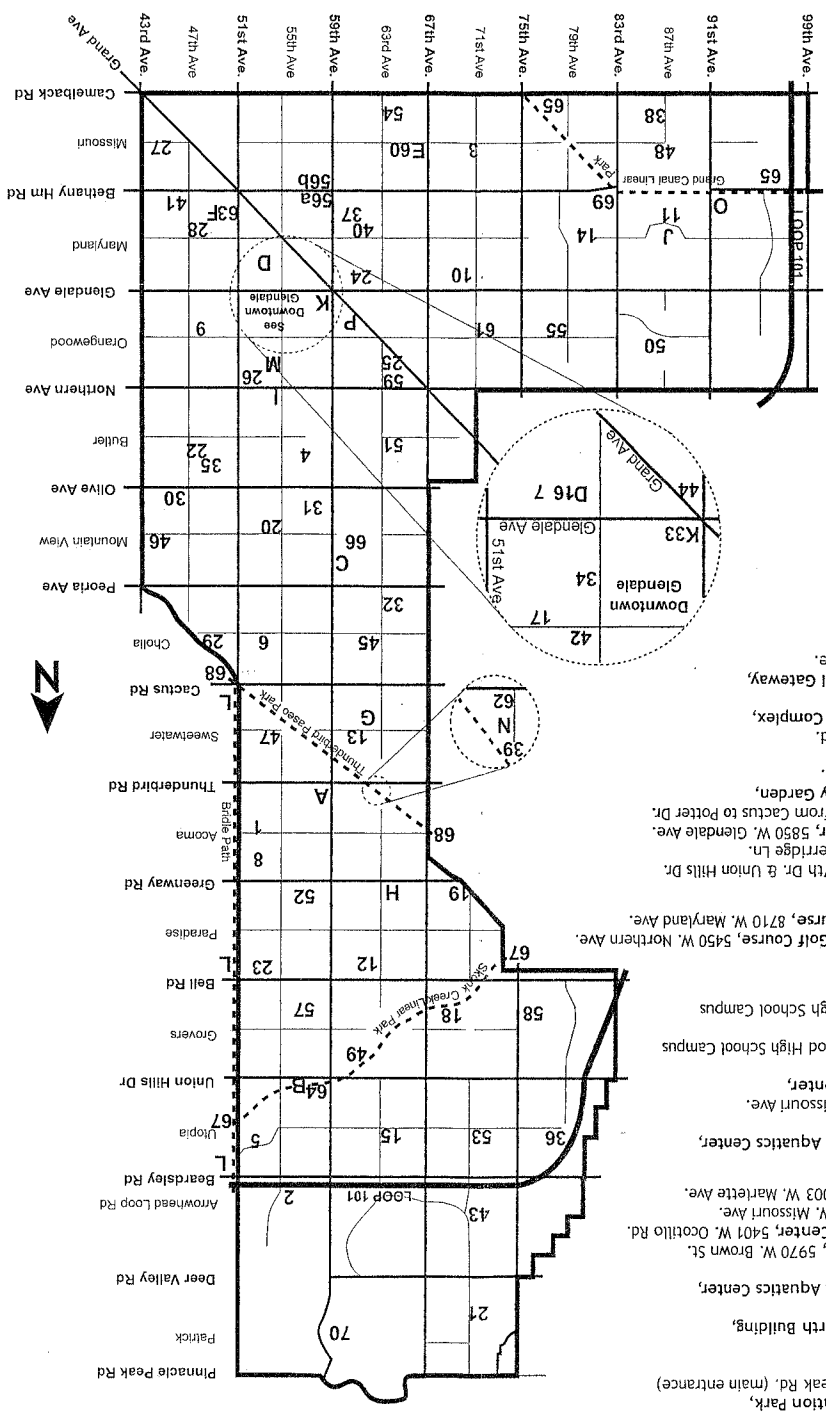

- CONSERVATION PARKS (200+ ACRES)**
- 70 Thunderbird Conservation Park, 59th Ave. & Pinnacle Peak Rd. (main entrance)
 - 3 Arrowhead Lakes Park, 56th Ave. & Mohawk Ln.
 - 1 Acoma Park, 53rd Ave. & Acoma Rd.
- SMALL AND NEIGHBORHOOD PARKS (UP TO 10 ACRES)**
- 1 Acoma Park, 53rd Ave. & Acoma Rd.
 - 2 Arrowhead Lakes Park, 56th Ave. & Mohawk Ln.
 - 3 Bicentennial Park, 71st Ave. & Missouri Ave.
 - 4 Butler Park, 57th Ave. & Alice Ave.
 - 5 Carmel Park, 52nd Dr. & Orabi Dr.
 - 6 Cholla Park, 53rd Ave. & Cholla St.
 - 7 Clavelito Park, 53rd Ave. & Ocotillo Rd.
 - 8 Country Gables Park, 52nd Ave. & Country Gables Dr.
 - 9 Delicias Park, 48th Dr. & Orangewood Ave.
 - 10 Desert Garden Park, 69th Ave. & Ocotillo Rd.
 - 11 Desert Mirage Park, 87th Ave. & Maryland Ave.
 - 12 Desert Rose Park, 63rd Ave. & Kings Ave.
 - 13 Desert Valley Park, 61st Ave. & Sweetwater Ave.
 - 14 Discovery Park, 79th Ave. & Maryland Ave.
 - 15 Dos Lagos Park, 63rd Ave. & Utopia Rd.
 - 16 El Barrio Park, 54th Ave. & Ocotillo Rd.
 - 17 Gardenwood Park, 53rd Ave. & Orangewood Ave.
 - 18 Greenbriar Park, 69th Ave. & Greenbriar Dr.
 - 19 Greenway Granada Park, 73rd Ave. & Greenway Rd.
 - 20 Heritage Park, 55th Ave. & Mountain View Rd.
 - 21 Hillcrest Park, 71st Ave. & Hillcrest Blvd.
 - 22 Horizon Park, 47th Ave. & Diana Ave.
 - 23 Kings Park, 53rd Ave. & Kings Ave.
 - 24 Lawrence Park, 62nd Ave. & Lawrence Rd.
 - 25 Lions Park, 63rd Ave. & Haywood Ave.
 - 26 Manistee Ranch Park, 52nd Ave. & Northern Ave.
 - 27 Mary Silva Park, 45th Ave. & Marshall Ave.
 - 28 Maryland Lakes Park, 47th Ave. & Maryland Ave.
 - 29 Menning Park, 49th Ave. & Cholla St.
 - 30 Mission Park, 47th Ave. & Sunnyslope Ln.
 - 31 Mondo Park, 57th Ave. & Hatcher Rd.
 - 32 Montara Park, 64th Ave. & Becker Ln.
 - 33 Murphy Park, 58th Ave. & Glendale Ave.
 - 34 Myrtle Park, 55th Ave. & Myrtle Ave.
 - 35 New World Park, 48th Dr. & Golden Ln.
 - 36 Oasis Park, 79th Ave. & Utopia Rd.
 - 37 Ocotillo Rose Park, 61st Ave. & Keim Rd.
 - 38 Pasadena Park, 87th Ave. & Pasadena Ave.
 - 39 Paseo Neighborhood Park, 14099 N. 63rd Ave.
 - 40 Plaza Rosa Park, 61st Ave. & Maryland Ave.
 - 41 Rovey Park, 47th Ave. & Rovey Ave.
 - 42 Sands Park, 55th Ave. & Orangewood Ave.
 - 43 Sierra Verde Park, 71st Ave. & Rose Garden Ln.
 - 44 Sonorita Park, 58th Dr. & Market St.
 - 45 Sunnyside Park, 63rd Ave. & Cholla St.
 - 46 Sunset Park, 45th Ave. & Mountain View Rd.
 - 47 Sunset Palms Park, 54th Ave. & Sweetwater Ave.
 - 48 Sunset Ridge Park, 87th Ave. & Missouri Ave.
 - 49 Sunset Vista Park, 64th Ave. & Villa Rita Dr.
 - 50 Sycamore Grove Park, 86th Ln. & Emil Rovey Pkwy.
 - 51 Tarrington Ranch Park, 63rd Ave. & Butler Dr.
 - 52 Tierra Buena Park, 57th Ave. & Tierra Buena Ln.
 - 53 Utopia Park, 72nd Ave. & Utopia Rd.
 - 54 Windsor Park, 63rd Ave. & Windsor Blvd.
 - 55 Unnamed Park, 79th Ave. & Orangewood Ave.
- COMMUNITY PARKS (1 TO 25 ACRES)**
- 56a Bonnell Park North, 59th Ave. & Bethany Home Rd.
 - 56b Bonnell Park South, 59th Ave. & Bethany Home Rd.
 - 57 Chapparral Park, 57th Ave. & Greenbriar Dr.
 - 58 Hidden Meadows Park, 76th Ave. & Northern Ave.
 - 59 Northern Horizon Park, 63rd Ave. & Northern Ave.
 - 60 O'Neil Park, 64th Ave. & Missouri Ave.
 - 61 Orangewood Park, 72nd Ave. & Orangewood Ave.
 - 62 Paseo Racquet Center & Park, 63rd Ave. & Thunderbird Rd.
 - 63 Rose Lane Park, 51st Ave. & Marlette Ave.
- REGIONAL PARKS (25 TO 200 ACRES)**
- 64 Footbills Park, 57th Ave. & Union Hills Dr.
 - 65 Grand Canal Linear Park
 - 66 Sahuaro Ranch Park, 59th Ave. & Mountain View Rd.
 - 67 Skunk Creek Linear Park, 51st Ave. & Utopia to 73rd Ave. & Greenway
 - 68 Thunderbird Paseo Park, 51st Ave. & Cactus to 72nd Ave. & Greenway
 - 69 Regional Park, 83rd Ave. & Bethany Home Rd.
- ADDITIONAL FACILITIES**
- 64 Footbills 5x8 Court, 57th Dr. & Union Hills Dr.
 - 69 X-Court, 59th Ave. & Berridge Ln.
 - K Glendale Amphitheater, 5850 W. Glendale Ave.
 - L Bridge Park, 51st Ave. from Cactus to Potter Dr.
 - M: Elsie McCarty Sensory Garden, 55th Ave. & Morten Ave.
 - N Myrtle Park, 55th Ave. & Myrtle Ave.
 - O Glendale Youth Sports Complex, 6268 W. Thunderbird Rd.
 - P Myrtle Avenue Cultural Gateway, 6220 N. 91st Ave.
- GOLF COURSES**
- I Glen Lakes Municipal Golf Course, 5450 W. Northern Ave.
 - J Desert Mirage Golf Course, 8710 W. Maryland Ave.
- POOLS**
- A Community Center North Building, 14075 N. 59th Ave.
 - B Footbills Recreation & Aquatics Center, 5600 W. Union Hills Dr.
 - C Glendale Adult Center, 5970 W. Brown St.
 - D Glendale Community Center, 5401 W. Ocotillo Rd.
 - E O'Neil Building, 6448 W. Missouri Ave.
 - F Rose Lane Building, 5003 W. Marlette Ave.
- RECREATION CENTERS**
- A Community Center North Building, 14075 N. 59th Ave.
 - B Footbills Recreation & Aquatics Center, 5600 W. Union Hills Dr.
 - C Glendale Adult Center, 5970 W. Brown St.
 - D Glendale Community Center, 5401 W. Ocotillo Rd.
 - E O'Neil Building, 6448 W. Missouri Ave.
 - F Rose Lane Building, 5003 W. Marlette Ave.
- POOLS**
- B Footbills Recreation & Aquatics Center, 5600 W. Union Hills Dr.
 - E O'Neil Pool, 6448 W. Missouri Ave.
- ADDITIONAL FACILITIES**
- M: Elsie McCarty Sensory Garden, 55th Ave. & Morten Ave.
 - N Myrtle Park, 55th Ave. & Myrtle Ave.
 - O Glendale Youth Sports Complex, 6268 W. Thunderbird Rd.
 - P Myrtle Avenue Cultural Gateway, 6220 N. 91st Ave.
- GOLF COURSES**
- I Glen Lakes Municipal Golf Course, 5450 W. Northern Ave.
 - J Desert Mirage Golf Course, 8710 W. Maryland Ave.